

Ⓚ = Kundenseitige Anschlussmaße  
 Required mating dimensions  
 Conditions requises pour le montage  
 Dimensioni di collegamento lato cliente  
 Cotas de montaje requeridas

ⓐ = Lagerung  
 Bearing  
 Roulement  
 Cuscinetto  
 Rodamiento

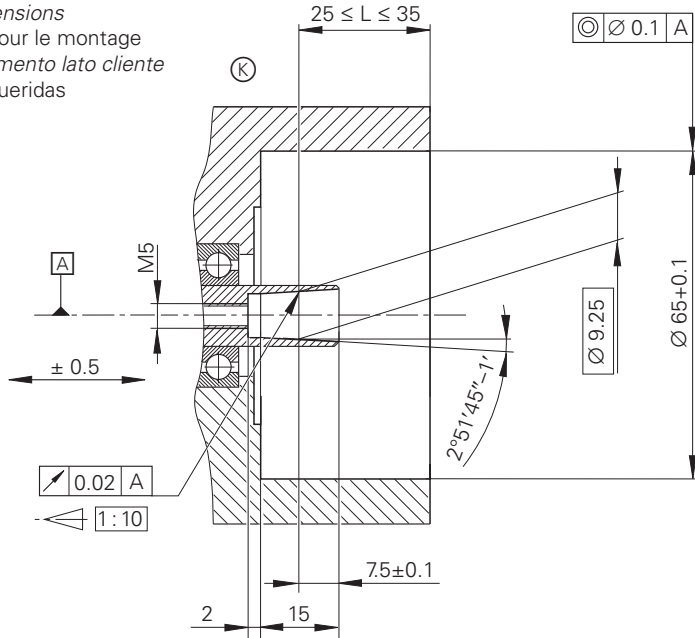

Maße in mm  
 Dimensions in mm  
 Cotes en mm  
 Dimensioni in mm  
 Dimensiones en mm

### Montage · Assembly · montage · montaggio · montaje

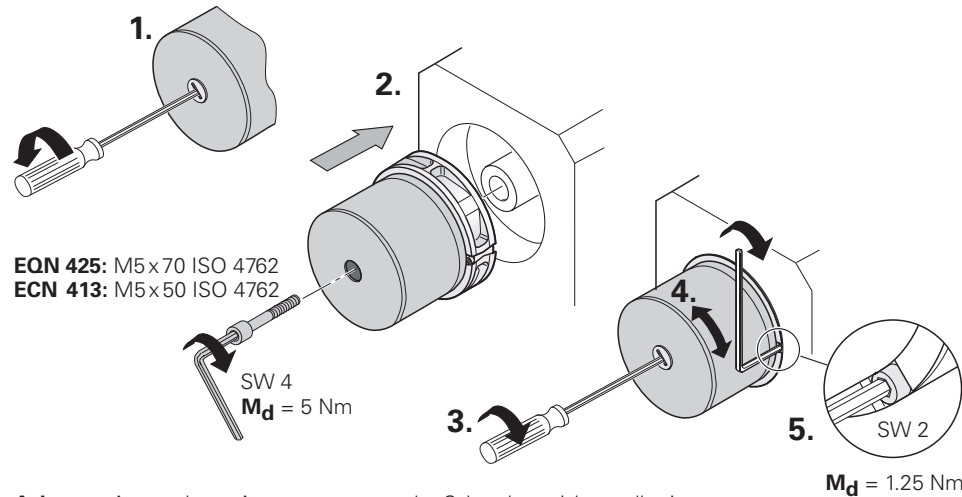

**Achtung:** Angegebene Anzugsmomente der Schrauben sicherstellen!  
**Note:** Be sure to tighten to the specified torque!  
**Attention:** Respecter les couples de serrage indiqués pour les vis!  
**Attenzione:** Serrare con la coppia specificata!  
**Atención:** ¡ Asegúrese de que el par de apriete de los tornillos sea el indicado!

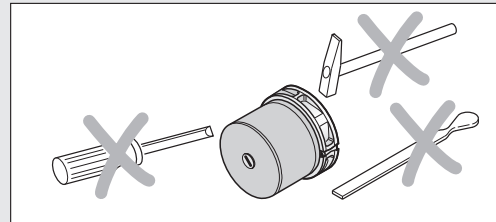
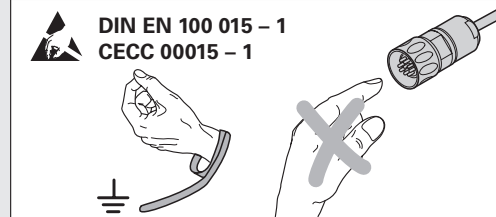
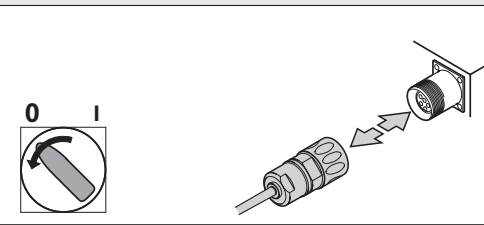

# HEIDENHAIN

Montageanleitung  
 Mounting Instructions  
 Instructions de montage  
 Istruzioni di montaggio  
 Instrucciones de montaje

## EQN 425

350 093-xx

## ECN 413

341 759-xx

6/2000

**DR. JOHANNES HEIDENHAIN GmbH**

Dr.-Johannes-Heidenhain-Straße 5

**83301 Traunreut, Germany**

☎ +49 (8669) 31-0

FAX +49 (8669) 5061

E-Mail: info@heidenhain.de

**Technical support** ☎ +49 (8669) 32-1000

**Measuring systems** ☎ +49 (8669) 31-3104

E-Mail: service.ms-support@heidenhain.de

**TNC support** ☎ +49 (8669) 31-3101

E-Mail: service.nc-support@heidenhain.de

**NC programming** ☎ +49 (8669) 31-3103

E-Mail: service.nc-pgm@heidenhain.de

**PLC programming** ☎ +49 (8669) 31-3102

E-Mail: service.plc@heidenhain.de

**Lathe controls** ☎ +49 (8669) 31-3105

E-Mail: service.lathe-support@heidenhain.de

[www.heidenhain.de](http://www.heidenhain.de)



Ve 00

352 424-91 · 6 · 7/2007 · E · Printed in Germany · Änderungen vorbehalten

Subject to change without notice · Sous réserve de modifications · Con riserva di modifiche · Sujeto a modificaciones

**EQN 425 EnDat/SSI**  
**ECN 413 EnDat/SSI**

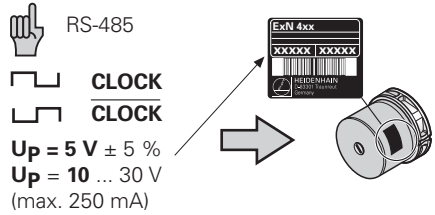

EN 50 178/4.98; 5.2.9.5  
IEC 364-4-41: 1992; 411(PELV/SELV)  
(siehe, see, voir, vedi, véase  
HEIDENHAIN D 231 929)

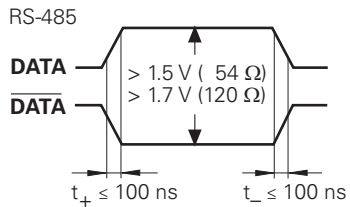
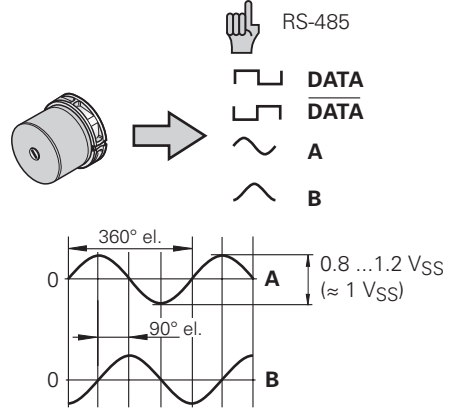
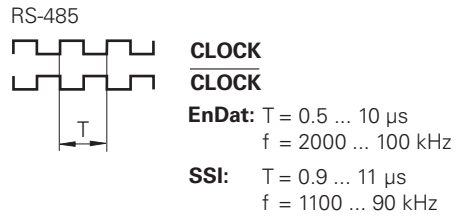

**Demontage · Disassembly · demontage · smontaggio · desmontaje**

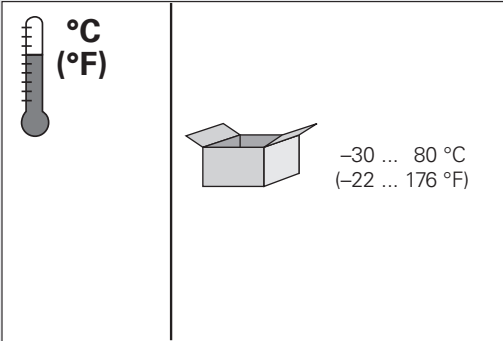
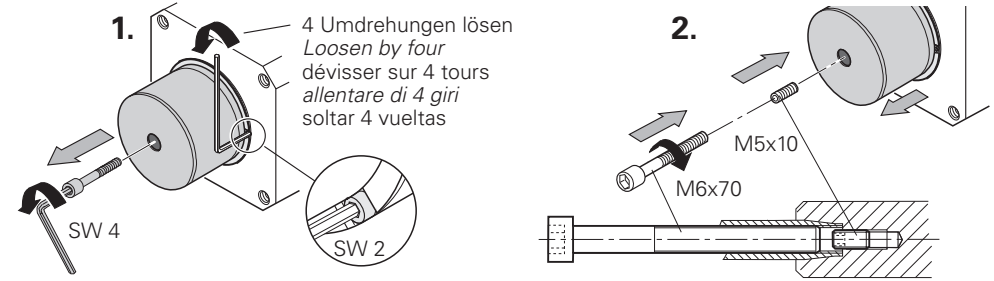

	$T \geq -40\text{ °C}$ (-40 °F)	$T \geq -10\text{ °C}$ (14 °F)
$\varnothing$	$R_1$	$R_2$
$\varnothing 6\text{ mm}$	$R_1 \geq 20\text{ mm}$	$R_2 \geq 75\text{ mm}$
$\varnothing 8\text{ mm}$	$R_1 \geq 40\text{ mm}$	$R_2 \geq 100\text{ mm}$

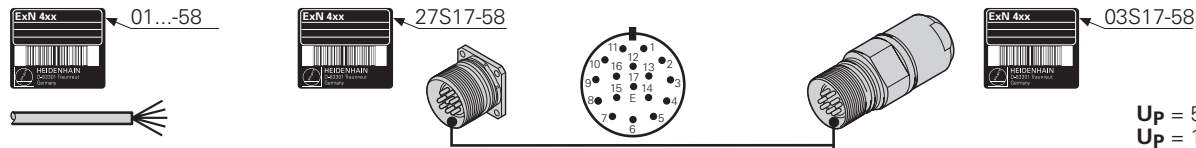

$U_p = 5\text{ V} \pm 5\%$   
 $U_p = 10 \dots 30\text{ V}$

1) Innenschirm Pin 11  
Internal shield pin 11  
blindage interne pin 11  
schermo interno pin 11  
blindaje interno pin 11

1	2	3	4	5	6	8	9	Schirm Shield blindage schermo blindaje	7	10	11	12	13	14	15	16	17
$U_p$ sensor	/	/	0V sensor	/	/	CLOCK	CLOCK		$U_p$	0V $U_N$	1)	B		DATA	A		DATA
												+	-		+	-	
blau blue bleu azzurro azul	schwarz black noir nero negro	rot red rouge rosso rojo	weiß white blanc bianco blanco	grün green vert verde	braun brown brun marrone marrón	violett violet violet viola violeta	gelb yellow jaune giallo amarillo		braun/grün brown/green brun/vert marrone/verde marrón/verde	weiß/grün white/green blanc/vert bianco/verde blanco/verde		blau/schwarz blue/black bleu/noir azzurro/nero azul/negro	rot/schwarz red/black rouge/noir rosso/hero rojo/negro	grau gray gris grigio gris	grün/schwarz green/black vert/noir verde/nero verde/hegroro	gelb/schwarz yellow/black jaune/noir giallo/nero amarillo/negro	rosa pink rose rosa rosa

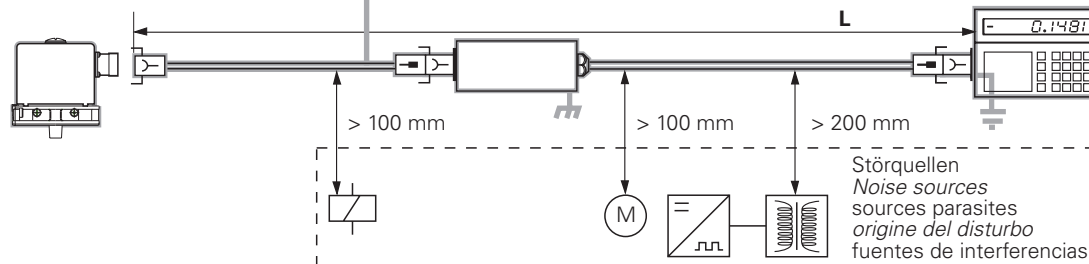

L	T	f
10 m	0.5...10µs	△ 2000...100 kHz
50 m	1.0...10µs	△ 1000...100 kHz
100 m	2.0...10µs	△ 500...100 kHz
150 m	3.3...10µs	△ 300...100 kHz